



**39 Culham Drive, Maidenhead, SL6 7PW**  
**£380,000 Freehold**

CHAIN FREE. A two bedroom home situated in a popular residential area, close to local shops and vast spaces of countryside. The property is located in a good school catchment area and is within walking distance of Furze Platt train station for connecting trains to Maidenhead, London and the Elizabeth Line.

## **Entrance Hall**

### **Sitting/Dining Room**

Sliding patio doors opening onto rear garden, arched opening to kitchen.

### **Kitchen**

Comprising range of wall and base cupboards and drawers, work surfaces incorporating stainless steel sink, tiled splashbacks, including tall fridge/freezer, washing machine and cooker (with extractor fan above), water softener, door leading to garden.

### **Stairs leading from Entrance Hall to:**

#### **First floor landing**

### **Bathroom**

White suite of WC, wash hand basin, panelled bath with power shower over, glass screen, fully tiled, heated towel rail, mirrored cabinet.

### **Bedroom 1**

Built in double mirrored wardrobe, storage cupboard, fully insulated and part boarded loft with access via pull down loft ladder.

### **Bedroom 2**

### **Outside**

Enclosed private garden with rear gate access.

### **Garage**

Garage in block, allocated parking in front of garage.



Floor Plan

Approximate Floor Area = 60.6 sq m / 652 sq ft  
Garage = 12 sq m / 129 sq ft  
Total = 72.6 sq m / 781 sq ft

Culham Drive

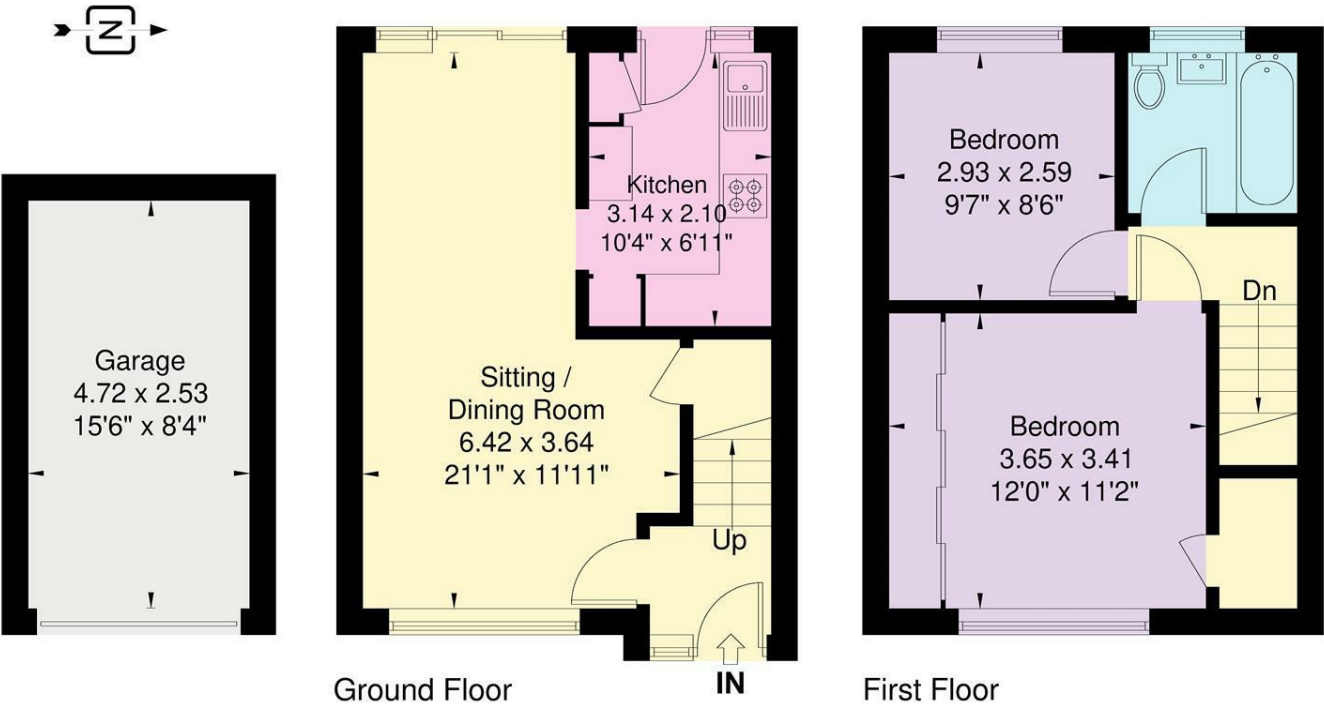
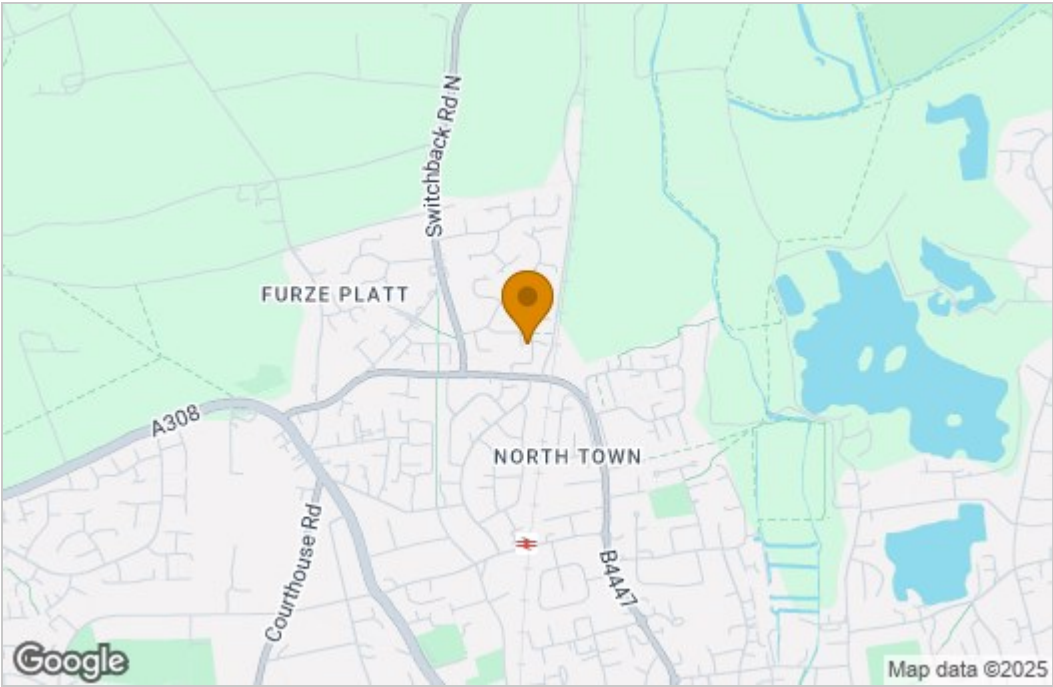
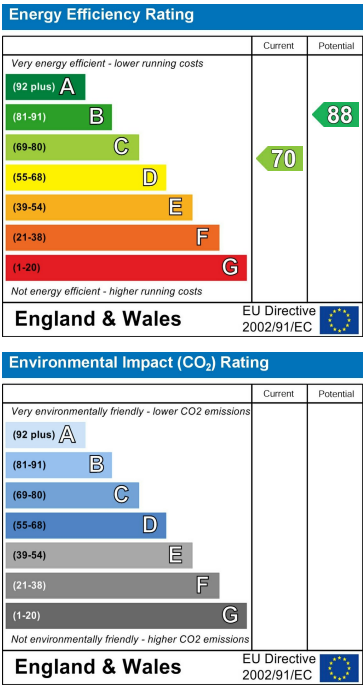

Illustration for identification purposes only,  
measurements are approximate, not to scale.

Area Map



Energy Efficiency Graph



These particulars, whilst believed to be accurate are set out as a general outline only for guidance and do not constitute any part of an offer or contract. Intending purchasers should not rely on them as statements of representation of fact, but must satisfy themselves by inspection or otherwise as to their accuracy. No person in this firm's employment has the authority to make or give any representation or warranty in respect of the property.